

**Central Howell - FY23 E-rate wiring**

upgrade proposal - **v2**

**Updated: 2/08/2023**

Changed from 3 x drops in the basement to 3 x IC drops

● New Simplex Outlet (1)

● New IC Simplex (3)

■ MDF 01

■ IDF 03

■ IDF 02

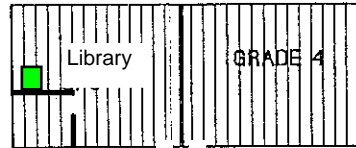
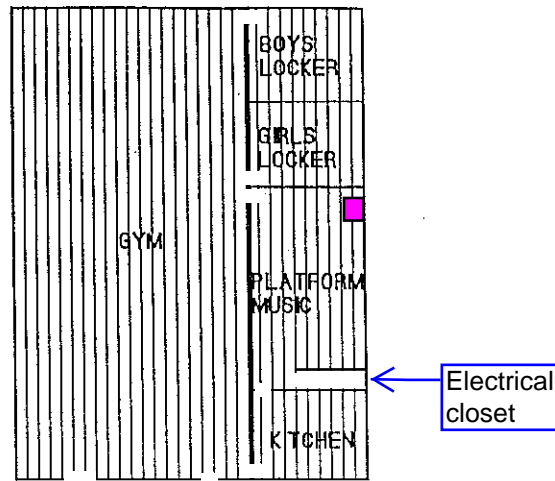

CENTRAL HOWELL ELEMENTARY SCHOOL

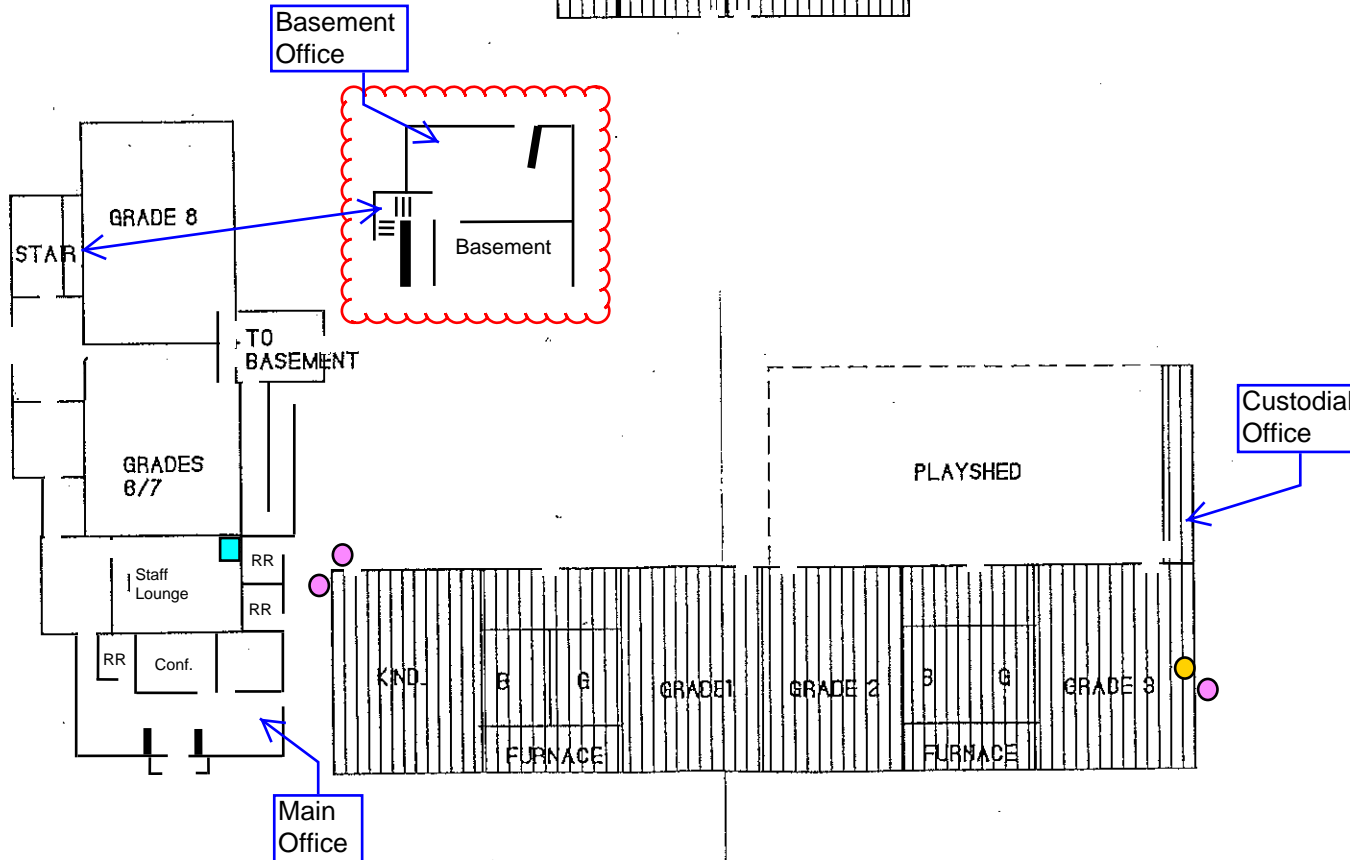

□ ORIGINAL BUILDING  
 ▨ UNKNOWN